

SYMBOLISATION - FONCTION VÉRINS COMPACTS C(D)Q2

Nouvelle génération de vérins compacts tailles 12 à 100 en double effet, tailles 12 à 63 en simple effet, avec ou sans détection magnétique. Extrémité de tige filetée ou taraudée. Amélioration technique permettant une interchangeabilité avec les principaux fabricants.



Double effet simple tige pneumatique/magnétique
Tailles 12 à 100



Double effet tige traversante pneumatique/magnétique
Tailles 12 à 100



Simple effet tige rentrée pneumatique/magnétique
Tailles 12 à 63



Simple effet tige sortie pneumatique/magnétique
Tailles 12 à 63



SPÉCIFICATIONS VÉRINS COMPACTS C(D)Q2

Taille (mm)	12	16	20	25	32	40	50	63	80	100
Fluide	Air filtré 40μ									
Opération	Double Effet									
	Simple Effet: tige rentrée, tige sortie								--	
Pression d'épreuve en Mpa (bar)	1.5 (15)									
Pression d'utilisation en Mpa (bar)	D.E. : 0.1~1.0 (1~10)									
	S.E. : 0.2~0.9 (2~9)								--	
Température d'utilisation en °C	-20 ~ +70									
Vitesse en mm/s	D.E.				30~500		30~350		30~250	
	S.E.				50-500				--	
Tolérance de course en mm	0 ; +1.0									
Lubrification	Non requise									
Montage	Trou traversant (option B), taraudage sur les 2 faces (option A)									
Orifices	M5 x 0.8				G1/8		G1/4		G3/8	

Tableau des courses & détecteurs

Taille	Courses standard (mm)	*Cse S.E.	Détecteurs
12, 16	5, 10, 15, 20, 25, 30	5, 10, 15, 20	Reed D-A93L
20, 25	5, 10, 15, 20, 25, 30, 35, 40, 45, 50	5, 10, 15, 20, 25, 30	
32, 40	5, 10, 15, 20, 25, 30, 35, 40, 45, 50, 75, 100	5, 10, 15, 20, 25, 30	
50, 63		5, 10, 15, 20, 25, 30	
80, 100		--	

*Cse S.E.: Courses en version Simple Effet

RÉFÉRENCE VÉRINS COMPACTS C(D)Q2

C **D** **Q2** **W** **B** **32** - **30** - **D** - **M**

Extrémité de tige Taraudée: blanc,
Filetée: M

Double effet : D,
Simple effet tige rentrée: S, tige sortie: T (1)

Courses: 5 à 100 (selon taille & modèle)

Tailles: 12, 16, 20, 25, 32, 40, 50, 63, 80, 100

Fixation mode: Trou lisse traversant lamé: B
Trou lisse traversant taraudé: A

Tige: simple: blanc, traversante: W

Vérin compact sans aimant: CQ2, avec aimant: CDQ2

RÉFÉRENCE DES DÉTECTEURS

(à commander séparément)

12, 16, 20	D-A93L	Détecteur "REED" DC/AC 5~240V
25, 32, 40		
50, 63, 80		
100		

Les détecteurs sont à commander séparément des vérins CDQ2

(1): les versions simple effet sont valables du ø12 au ø63.

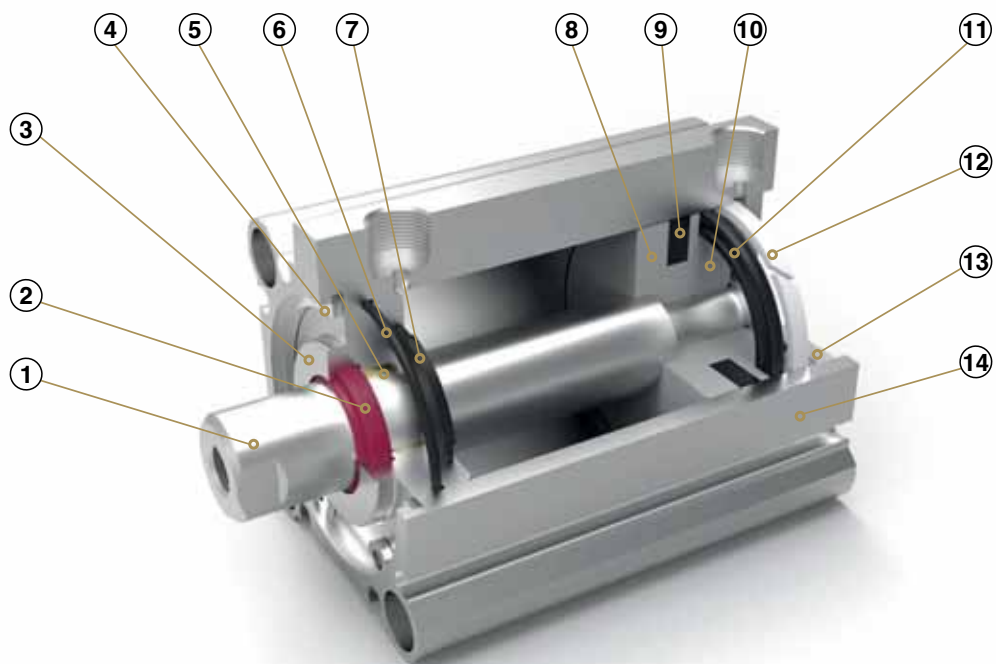

Repère	Désignation	Q.té	Repère	Désignation	Q.té
1	Tige piston	1	8	Piston	2
2	Joint de tige	1	9	Aimant	1
3	Flasque avant	1	10	Support aimant	1
4	Circlips	1	11	Joint de piston	1
5	Bague DU	1	12	Bague anti-friction	1
6	O'ring tube	1	13	Flasque arrière	1
7	Bague amortisseur	1	14	Tube corps	

DIMENSIONS VÉRINS COMPACTS CQ2 TAILLES 12 à 25

CQ2B

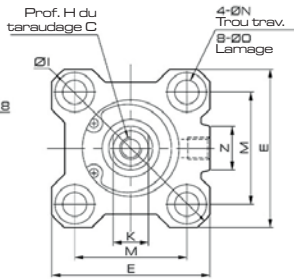
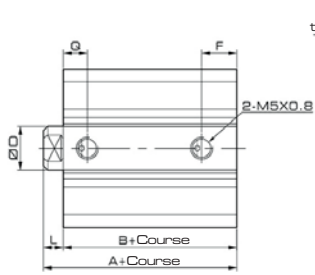

CQ2-M

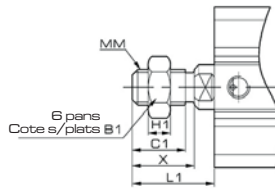

CQ2A

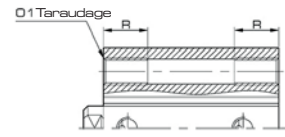

CQ2 Double effet

Modèle	C.se	A	B	C	D	E	F	H	I	K	L	M	N	O	Q	Z	B1	C1	H1	L1	MM	X	O1	R
CQ2B12	5~30	20.5	17	6	6	25	5	M3X0,5	32	5	3.5	15.5	3.5	6,5 prof.3.5	7,5	--	8	9	4	14	M5x0,8	10.5	M4	7
CQ2B16	5~30	22	18.5	8	8	29	5.5	M4X0,7	38	6	3.5	20	3.5	6,5 prof.3.5	8	10	10	10	5	15.5	M6x1	12	M4	7
CQ2B20	5~50	24	19.5	7	10	36	5.5	M5X0,8	47	8	4.5	25.5	5.5	9 prof.7	8	10	13	12	5	18.5	M8X1.25	14	M6	10
CQ2B25	5~50	27.5	22.5	12	12	40	5.5	M6X1	52	10	5	28	5.5	9 prof.7	9	10	17	15	6	22.5	M10X1.25	17.5	M6	10

DIMENSIONS VÉRINS COMPACTS CQ2 TAILLES 32 à 100

CQ2B

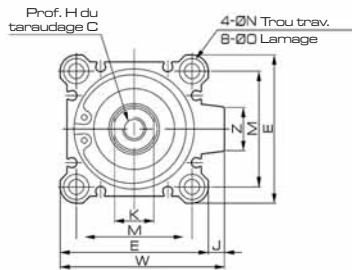
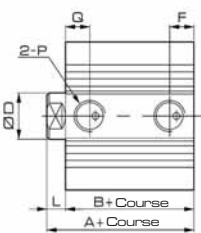

CQ2-M

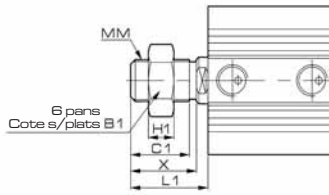

CQ2A

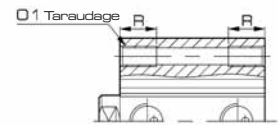

CQ2 Double effet

Modèle	C.se	Sans Aimant				Avec Aimant				C	D	E	H	J	K	L	M	O	P	W	Z	B1	C1	H1
		A	B	F	Q	A	B	F	Q															
CQ2B32	5	30	23	6.5	7.5	40	33	7.5	10	13	16	45	M8x1,25	4.5	14	7	34	9 prof. 7	1/8	49.5	14	22	20.5	8
	10~50			7.5	10																			
	51~100	40	33																					
CQ2B40	5	36.5	29.5	8	11	46.5	39.5	7.5	12.5	13	16	52	M8x1,25	5	14	7	40	9 prof. 7	1/8	57	15	22	20.5	8
	10~50			7.5	12.5																			
	51~100	46.5	39.5																					
CQ2B50	5	38.5	30.5	9	9	48.5	40.5	10.5	10.5	15	20	64	M10x1.5	7	17	8	50	11 prof. 8	1/4	71	19	27	26	11
	10~50			10.5	10.5																			
	51~100	48.5	40.5																					
CQ2B63	5	44	36	9.5	14	54	46	10.5	15	15	20	77	M10x1.5	7	17	8	60	14 prof. 10.5	1/4	84	19	27	26	11
	10~50			10.5	15																			
	51~100	54	46																					
CQ2B80	5~50	53.5	43.5	12.5	16	63.5	53.5	12.5	16	21	25	98	M16X2	6	22	10	77	17.5 prof. 13.5	3/8	104	25	32	32.5	13
	51~100	63.5	53.5																					
CQ2B100	5~50	65	53	13	23	75	63	13	23	27	32	117	M20X2.5	6.5	27	12	94	17.5 prof. 13.5	3/8	123.5	25	41	32.5	13
	51~100	75	63																					

Modèle	L1	MM	X	D	R
CQ2B32	28.5	M14x1.5	23.5	M6x1	10
CQ2B40	28.5	M14x1.5	23.5	M6x1	10
CQ2B50	33.5	M18x1.5	28.5	M8x1.25	14
CQ2B63	33.5	M18x1.5	28.5	M10x1.5	18
CQ2B80	43.5	M22x1.5	35.5	M12x1.75	22
CQ2B100	43.5	M26x1.5	35.5	M12x1.75	22

DIMENSIONS VÉRINS COMPACTS CQ2W Double Effet Tige Traversante T.12 à 25

CQ2WB

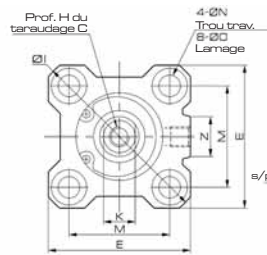
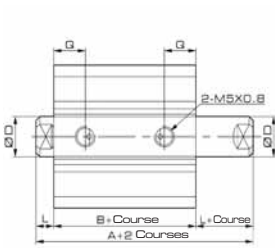

CQ2W-M

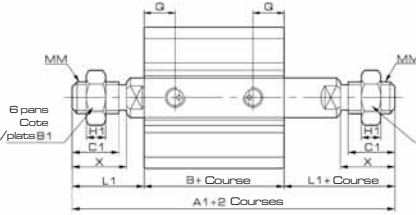

CQ2WA

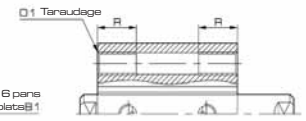

CQ2W Tige traversante

Modèle	C.se	A	B	C	D	E	H	I	K	L	M	N	O	Q	Z	A1	B1	C1	H1	L1	MM	X	O1	R
CQ2BW12	5~30	32.2	25.2	6	6	25	M3X0,5	32	5	3.5	15.5	3.5	6,5 prof.3.5	9	--	43.2	8	9	4	14	M5	10.5	M4	7
CQ2BW16	5~30	33	26	8	8	29	M4X0,7	38	6	3.5	20	3.5	6,5 prof.3.5	9.5	10	57	10	10	5	15.5	M6	12	M4	7
CQ2BW20	5~30	35	26	7	10	36	M5X0,8	47	8	4.5	25.5	5.5	9 prof.7	8	10	63	13	12	5	18.5	M8	14	M6	10
CQ2BW25	5~30	39	29	12	12	40	M6X1	52	10	5	28	5.5	9 prof.7	9	10	74	17	15	6	22.5	M10	17.5	M6	10

DIMENSIONS VÉRINS COMPACTS CQ2W Double Effet Tige Traversante T.32 à 100

CQ2WB

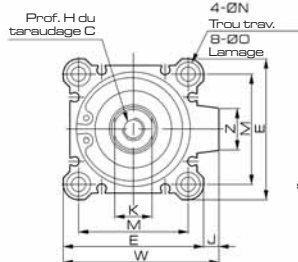
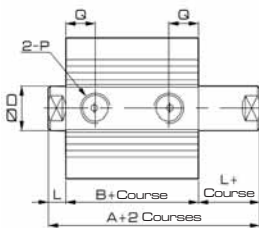

CQ2W-M

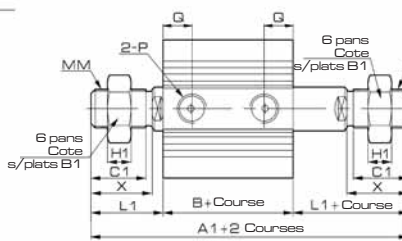

CQ2WA

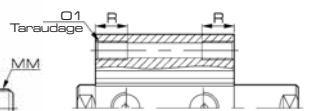

CQ2W Tige traversante

Modèle	C.se	Sans Aimant			Avec Aimant			C	D	E	H	J	K	L	M	N	O	P	Q
		A	A1	B	A	A1	B												
CQ2W32	5~50	44.5	87.5	30.5	54.5	97.5	40.5	13	16	45	M8x1,25	4.5	14	7	34	5,5	9 prof. 7	1/8	10
	50~100	54.5	97.5	40.5															
CQ2W40	5~50	54	97	40	64	107	50	13	16	52	M8x1,25	5	14	7	40	5.5	9 prof. 7	1/8	13
	50~100	64	107	50															
CQ2W50	5~50	56.5	107.5	40.5	66.5	117.5	50.5	15	20	64	M10x1.5	7	17	8	50	6.6	11 prof. 8	1/4	13
	50~100	66.5	117.5	50.5															
CQ2W63	5	48	109	42	68	119	52	15	20	77	M10x1.5	7	17	8	60	9	14 prof. 10.5	1/4	Course 5: 14.5 C.ses 10~50 / 50~100: 16
	10~50	68	119	52															
CQ2W80	5~50	71	138	51	81	148	61	21	25	98	M16x2	6	22	10	77	11	17 prof. 13.5	3/8	3/8
	50~100	81	148	61															
CQ2W100	5~50	84.5	147.5	60.5	94.5	157.5	70.5	27	32	117	M20x2.5	6.5	27	12	94	11	17 prof. 13.5	3/8	3/8
	50~100	94.5	157.5	70.5															

Modèle	W	Z	B1	C1	H1	L1	MM	X	O1	R
CQ2W32	49.5	14	22	20.5	8	28.5	M14x1.5	23.5	M6x1	10
CQ2W40	57	15	22	20.5	8	28.5	M14x1.5	23.5	M6x1	10
CQ2W50	71	19	27	26	11	33.5	M18x1.5	28.5	M8x1.25	14
CQ2W63	84	19	27	26	11	33.5	M18x1.5	28.5	M10x1.5	18
CQ2W80	104	25	32	32.5	13	43.5	M22x1.5	35.5	M12x1.75	22
CQ2W100	123.5	25	41	32.5	16	43.5	M26x1.5	35.5	M12x1.75	22



DIMENSIONS VÉRINS COMPACTS CQ2 Simple Effet Tige Rentrée T. 12 à 25

CQ2B-S

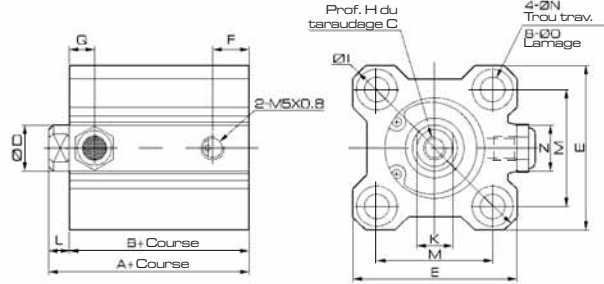

CQ2-S-M

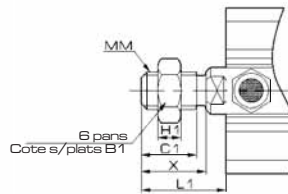

CQ2A-S

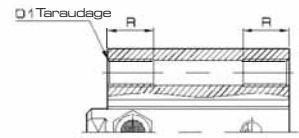

CQ2-S Simple effet

Modèle	C.se	A	B	C	D	E	F	H	I	K	L	M	N	O	Q	Z	B1	C1	H1	L1	MM	X	O1	R
CQ2B12-S	5/10	30.5	27	6	6	25	5	M3X0,5	32	5	3.5	15.5	3.5	6,5 prof.3.5	7,5	--	8	9	4	14	M5	10.5	M4	7
	15/20	40.5	37																					
CQ2B16-S	5/10	32	28.5	8	8	29	5.5	M4X0,7	38	6	3.5	20	3.5	6,5 prof.3.5	8	10	10	10	5	15.5	M6	12	M4	7
	15/20	42	38.5																					
CQ2B20-S	5/10	34	29.5	7	10	36	5.5	M5X0,8	47	8	4.5	25.5	5.5	9 prof.7	8	10	13	12	5	18.5	M8	14	M6	10
	15/20/25/30	44	39.5																					
CQ2B25-S	5/10	37.5	32.5	12	12	40	5.5	M6X1	52	10	5	28	5.5	9 prof.7	9	10	17	15	6	22.5	M10	17.5	M6	10
	15/20/25/30	47.5	42.5																					

DIMENSIONS VÉRINS COMPACTS CQ2 Simple Effet Tige Rentrée T. 32 à 63

CQ2B-S

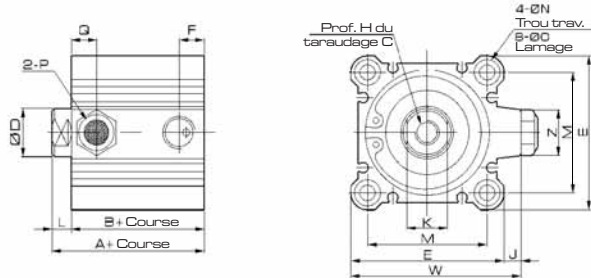

CQ2-S-M

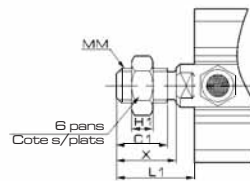

CQ2A-S

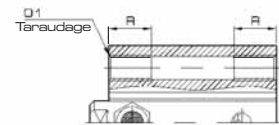

CQ2-S Simple effet

Modèle	C.se	Sans Aimant				Avec Aimant				C	D	E	H	J	K	L	M	N	O	P	W	Z	B1	C1
		A	B	F	Q	A	B	F	Q															
CQ2B32-S	5/10	40	33	7.5	10	50	43	7.5	10	13	16	45	M8x1,25	4.5	14	7	34	5.5	9 prof. 7	1/8	49.5	14	22	20.5
	15/20/25/30	50	43			60	53																	
CQ2B40-S	5/10	36.5	29.5	7.5	12.5	56.5	49.5	7.5	12.5	13	16	52	M8x1,25	5	14	7	40	5.5	9 prof. 7	1/8	57	15	22	20.5
	15/20/25/30	46.5	39.5			66.5	59.5																	
CQ2B50-S	5/10	38.5	30.5	10.5	10	58.5	50.5	10.5	10.5	15	20	64	M10x1.5	7	17	8	50	6.6	11 prof. 8	1/4	71	19	27	26
	15/20/25/30	48.5	40.5			68.5	60.5																	
CQ2B63-S	5/10	44	36	10.5	15	64	56	10.5	15	15	20	77	M10x1.5	7	17	8	60	9	14 prof. 10.5	1/4	84	19	27	26
	15/20/25/30	54	46			74	66																	

Modèle	H1	L1	MM	X	O1	R
CQ2B32-S	8	28.5	M14x1.5	23.5	M6x1	10
CQ2B40-S	8	28.5	M14x1.5	23.5	M6x1	10
CQ2B50-S	11	33.5	M18x1.5	28.5	M8x1.25	14
CQ2B63-S	11	33.5	M18x1.5	28.5	M10x1.5	18



DIMENSIONS VÉRINS COMPACTS CQ2 Simple Effet Tige Sortie T. 12 à 25

CQ2B-T

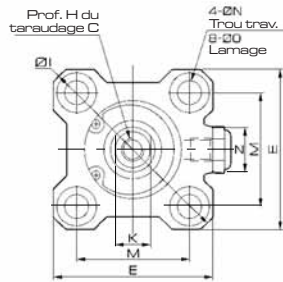
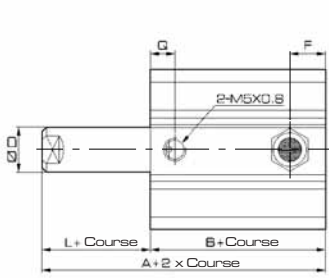

CQ2-T-M

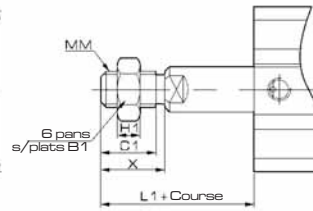

CQ2A-T

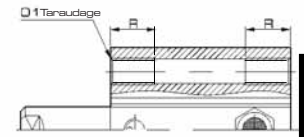

CQ2-T Simple effet

Modèle	C.se	A	B	C	D	E	F	H	I	K	L	M	N	O	Q	Z	B1	C1	H1	L1	MM	X	O1	R
CQ2B12-T	5/10	30.5	27	6	6	25	5	M3X0,5	32	5	3.5	15.5	3.5	6,5 prof.3.5	7,5	--	8	9	4	14	M5	10.5	M4	7
	15/20	40.5	37																					
CQ2B16-T	5/10	32	28.5	8	8	29	5.5	M4X0,7	38	6	3.5	20	3.5	6,5 prof.3.5	8	10	10	10	5	15.5	M6	12	M4	7
	15/20	42	38.5																					
CQ2B20-T	5/10	34	29.5	7	10	36	5.5	M5X0,8	47	8	4.5	25.5	5.5	9 prof.7	8	10	13	12	5	18.5	M8	14	M6	10
	15/20/25/30	44	39.5																					
CQ2B25-T	5/10	37.5	32.5	12	12	40	5.5	M6X1	52	10	5	28	5.5	9 prof.7	9	10	17	15	6	22.5	M10	17.5	M6	10
	15/20/25/30	47.5	42.5																					

DIMENSIONS VÉRINS COMPACTS CQ2 Simple Effet Tige Sortie T. 32 à 63

CQ2B-T

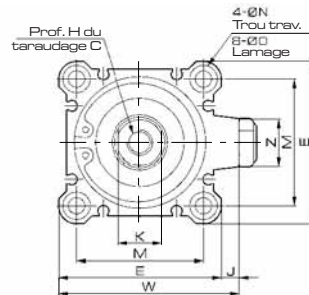
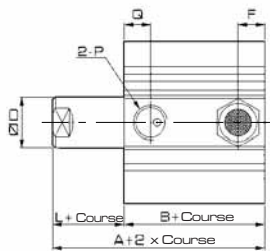

CQ2-T-M

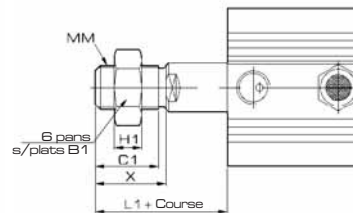

CQ2A-T

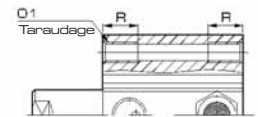

CQ2-T Simple effet

Modèle	C.se	Sans Aimant				Avec Aimant				C	D	E	H	J	K	L	M	N	O	P	W	Z	B1	C1
		A	B	F	Q	A	B	F	Q															
CQ2B32-T	5/10	40	33	7.5	10	50	43	7.5	10	13	16	45	M8x1,25	4.5	14	7	34	5.5	9 prof. 7	1/8	49.5	14	22	20.5
	15/20/25/30	50	43			60	53																	
CQ2B40-T	5/10	36.5	29.5	7.5	12.5	56.5	49.5	7.5	12.5	13	16	52	M8x1,25	5	14	7	40	5.5	9 prof. 7	1/8	57	15	22	20.5
	15/20/25/30	46.5	39.5			66.5	59.5																	
CQ2B50-T	5/10	38.5	30.5	10.5	10	58.5	50.5	10.5	10.5	15	20	64	M10x1.5	7	17	8	50	6.6	11 prof. 8	1/4	71	19	27	26
	15/20/25/30	48.5	40.5			68.5	60.5																	
CQ2B63-T	5/10	44	36	10.5	15	64	56	10.5	15	15	20	77	M10x1.5	7	17	8	60	9	14 prof. 10.5	1/4	84	19	27	26
	15/20/25/30	54	46			74	66																	

Modèle	H1	L1	MM	X	D	R
CQ2B32-T	8	28.5	M14x1.5	23.5	M6x1	10
CQ2B40-T	8	28.5	M14x1.5	23.5	M6x1	10
CQ2B50-T	11	33.5	M18x1.5	28.5	M8x1.25	14
CQ2B63-T	11	33.5	M18x1.5	28.5	M10x1.5	18



DIMENSIONS VÉRINS COMPACTS CDQ2 TAILLES 12 à 25

CDQ2A

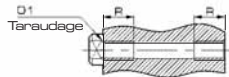

CDQ2-M

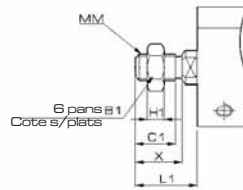

CDQ2B T.12

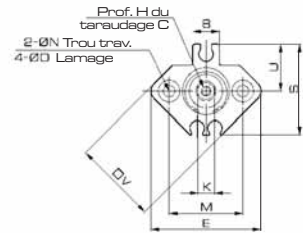

CDQ2B T.16 à 25

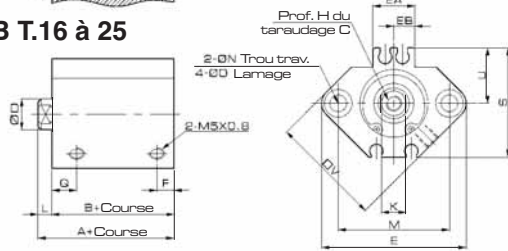

CDQ2 Double effet

Modèle	C.se	A	B	C	D	E	EA	EB	F	H	K	L	M	N	O	Q	S	U	V	B1	C1	H1	L1	MM	X	O1	R
CDQ2B12	5~30	31.5	28	6	6	33	--	--	7	M3	5	3.5	22	3.5	6,5 prof.3.5	9	27.5	14	25	8	9	4	14	M5	10.5	M4	7
CDQ2B16	5~30	34	30.5	8	8	37	13.2	6.6	5.5	M4	6	3.5	28	3.5	6,5 prof.3.5	9.5	29.5	15	29	10	10	5	15.5	M6	12	M4	7
CDQ2B20	5~50	36	31.5	7	10	47	13.6	6.8	5.5	M5	8	4.5	36	5.5	9 prof.7	8	35.5	18	36	13	12	5	18.5	M8	14	M6	10
CDQ2B25	5~50	37.5	32.5	12	12	52	13.6	6.8	5.5	M6	10	5	40	5.5	9 prof.7	9	40.5	21	40	17	15	6	22.5	M10	17.5	M6	10

DIMENSIONS VÉRINS COMPACTS CDQ2 TAILLES 32 à 100

CDQ2B

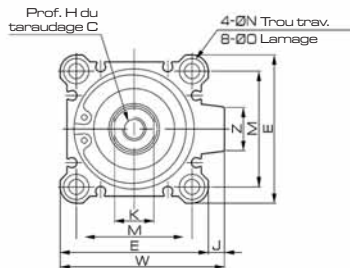
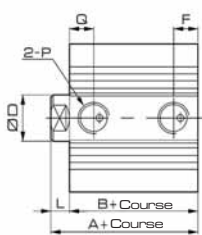

CDQ2-M

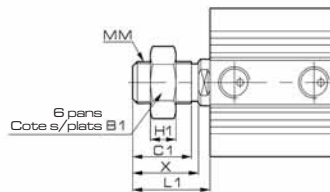

CDQ2A

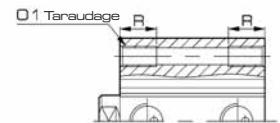

CDQ2 Double effet

Modèle	C.se	Sans Aimant				Avec Aimant				C	D	E	H	J	K	L	M	O	P	W	Z	B1	C1	H1
		A	B	F	Q	A	B	F	Q															
CDQ2B32	5	30	23	6.5	7.5	40	33	7.5	10	13	16	45	M8x1,25	4.5	14	7	34	9 prof. 7	1/8	49.5	14	22	20.5	8
	10~50	40	33	7.5	10																			
	51~100	40	33	7.5	10																			
CDQ2B40	5	36.5	29.5	8	11	46.5	39.5	7.5	12.5	13	16	52	M8x1,25	5	14	7	40	9 prof. 7	1/8	57	15	22	20.5	8
	10~50	46.5	39.5	7.5	12.5																			
	51~100	46.5	39.5	7.5	12.5																			
CDQ2B50	5	38.5	30.5	9	9	48.5	40.5	10.5	10.5	15	20	64	M10x1.5	7	17	8	50	11 prof. 8	1/4	71	19	27	26	11
	10~50	10.5	10.5																					
	51~100	48.5	40.5	9.5	14																			
CDQ2B63	5	44	36	9.5	14	54	46	10.5	15	15	20	77	M10x1.5	7	17	8	60	14 prof. 10.5	1/4	84	19	27	26	11
	10~50	10.5	15																					
	51~100	54	46																					
CDQ2B80	5~50	53.5	43.5	12.5	16	63.5	53.5	12.5	16	21	25	98	M16X2	6	22	10	77	17.5 prof. 13.5	3/8	104	25	32	32.5	13
	51~100	63.5	53.5																					
	5~50	65	53																					
CDQ2B100	5~50	65	53	13	23	75	63	13	23	27	32	117	M20X2.5	6.5	27	12	94	17.5 prof. 13.5	3/8	123.5	25	41	32.5	13
	51~100	75	63																					

Modèle	L1	MM	X	O1	R
CDQ2B32	28.5	M14x1.5	23.5	M6x1	10
CDQ2B40	28.5	M14x1.5	23.5	M6x1	10
CDQ2B50	33.5	M18x1.5	28.5	M8x1.25	14
CDQ2B63	33.5	M18x1.5	28.5	M10x1.5	18
CDQ2B80	43.5	M22x1.5	35.5	M12x1.75	22
CDQ2B100	43.5	M26x1.5	35.5	M12x1.75	22

DIMENSIONS VÉRINS COMPACTS MAGNETIQUES CDQ2W Tige Traversante T.12 à 25

CDQ2WA

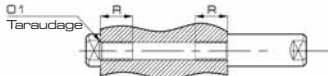

CDQ2W-M

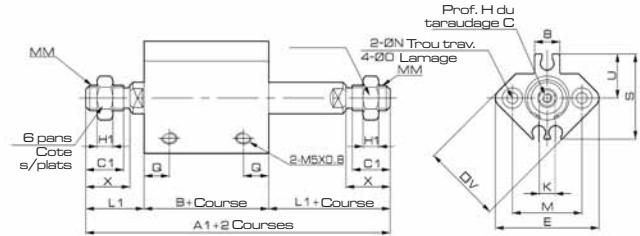

CDQ2WB T.12

CDQ2WB T.16 à 25

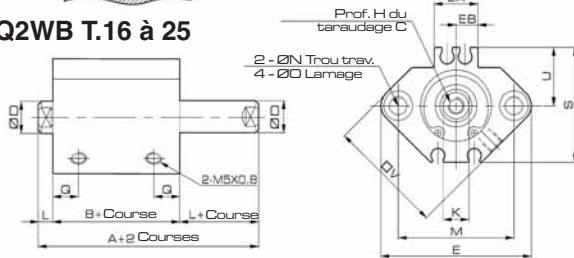

CDQ2W Tige traversante

Modèle	C.se	A	B	C	D	E	EA	EB	H	K	L	M	N	O	Q	S	U	V	A1	B1	C1	H1	L1	MM	X	O1	R
CDQ2B12	5~30	39.4	32.4	6	6	33	--	--	M3	5	3.5	22	3.5	6,5 prof.3.5	9	27.5	14	25	60.4	8	9	4	14	M5	10.5	M4	7
CDQ2B16	5~30	43	36	8	8	37	13.2	6.6	M4	6	3.5	28	3.5	6,5 prof.3.5	9.5	29.5	15	29	67	10	10	5	15.5	M6	12	M4	7
CDQ2B20	5~50	47	38	7	10	47	13.6	6.8	M5	8	4.5	36	5.5	9 prof.7	8	35.5	18	36	75	13	12	5	18.5	M8	14	M6	10
CDQ2B25	5~50	49	39	12	12	52	13.6	6.8	M6	10	5	40	5.5	9 prof.7	9	40.5	21	40	84	17	15	6	22.5	M10	17.5	M6	10

DIMENSIONS VÉRINS COMPACTS MAGNETIQUES CDQ2W Tige Traversante T.32 à 100

CDQ2WB

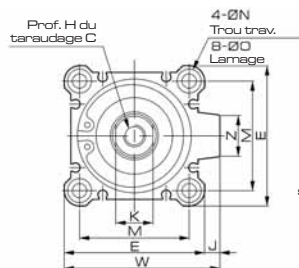
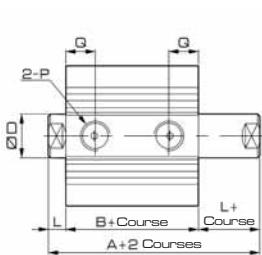

CDQ2W-M

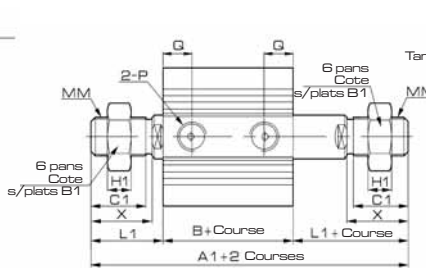

CDQ2WA

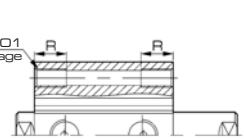

CDQ2W Tige traversante

Modèle	C.se	Sans Aimant			Avec Aimant			C	D	E	H	J	K	L	M	N	O	P	Q
		A	A1	B	A	A1	B												
CDQ2W32	5~50	44.5	87.5	30.5	54.5	97.5	40.5	13	16	45	M8x1,25	4.5	14	7	34	5,5	9 prof. 7	1/8	10
	50~100	54.5	97.5	40.5															
CDQ2W40	5~50	54	97	40	64	107	50	13	16	52	M8x1,25	5	14	7	40	5.5	9 prof. 7	1/8	13
	50~100	64	107	50															
CDQ2W50	5~50	56.5	107.5	40.5	66.5	117.5	50.5	15	20	64	M10x1.5	7	17	8	50	6.6	11 prof. 8	1/4	13
	50~100	66.5	117.5	50.5															
CDQ2W63	5	48	109	42	68	119	52	15	20	77	M10x1.5	7	17	8	60	9	14 prof. 10.5	1/4	Course 5: 14.5 C.ses 10~50 / 50~100: 16
	10~50																		
	50~100																		
CDQ2W80	5~50	71	138	51	81	148	61	21	25	98	M16x2	6	22	10	77	11	17 prof. 13.5	3/8	3/8
	50~100	81	148	61															
CDQ2W100	5~50	84.5	147.5	60.5	94.5	157.5	70.5	27	32	117	M20x2.5	6.5	27	12	94	11	17 prof. 13.5	3/8	3/8
	50~100	94.5	157.5	70.5															

Modèle	W	Z	B1	C1	H1	L1	MM	X	O1	R
CDQ2W32	49.5	14	22	20.5	8	28.5	M14x1.5	23.5	M6x1	10
CDQ2W40	57	15	22	20.5	8	28.5	M14x1.5	23.5	M6x1	10
CDQ2W50	71	19	27	26	11	33.5	M18x1.5	28.5	M8x1.25	14
CDQ2W63	84	19	27	26	11	33.5	M18x1.5	28.5	M10x1.5	18
CDQ2W80	104	25	32	32.5	13	43.5	M22x1.5	35.5	M12x1.75	22
CDQ2W100	123.5	25	41	32.5	16	43.5	M26x1.5	35.5	M12x1.75	22



DIMENSIONS VÉRINS COMPACTS CDQ2 Simple Effet Tige Rentrée T. 12 à 25

CDQ2B-S

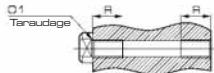

CDQ2B-S T.16 à 25

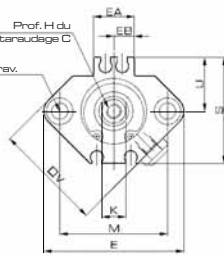
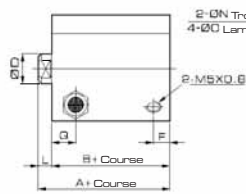

CDQ2-S-M

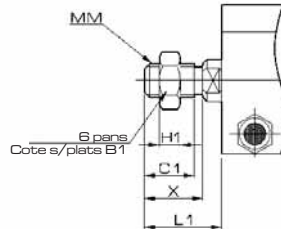

CDQ2B-S T.12

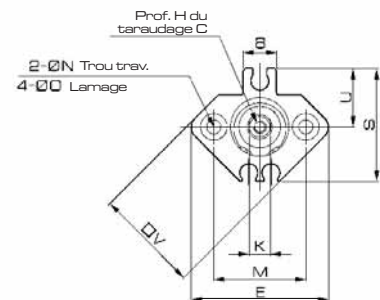

CDQ2-S Simple effet

Modèle	C.se	A	B	C	D	E	EA	EB	F	H	I	K	L	M	N	O	Q	S	U	V	B1	C1	H1	L1	MM	X	O1	R
CDQ2B12-S	5/10	41.5	38	6	6	33	--	--	7	M3	32	5	3.5	22	3.5	6,5 prof.3.5	7,5	27.5	14	25	8	9	4	14	M5	10.5	M4	7
	15/20	51.5	48																									
CDQ2B16-S	5/10	44	40.5	8	8	37	13.2	6.6	5.5	M4	38	6	3.5	28	3.5	6,5 prof.3.5	8	29.5	15	29	10	10	5	15.5	M6	12	M4	7
	15/20	54	50.5																									
CDQ2B20-S	5/10	46	41.5	7	10	47	13.6	6.8	5.5	M5	47	8	4.5	36	5.5	9 prof.7	8	35.5	18	36	13	12	5	18.5	M8	14	M6	10
	15/20/25/30	56	51.5																									
CDQ2B25-S	5/10	47.5	42.5	12	12	52	13.6	6.8	5.5	M6	52	10	5	40	5.5	9 prof.7	9	40.5	21	40	17	15	6	22.5	M10	17.5	M6	10
	15/20/25/30	52.5	52.5																									

DIMENSIONS VÉRINS COMPACTS CDQ2 Simple Effet Tige Rentrée T. 32 à 63

CDQ2B-S

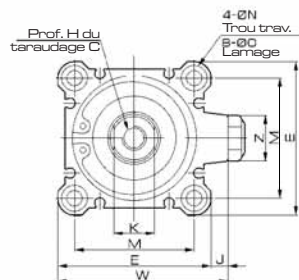
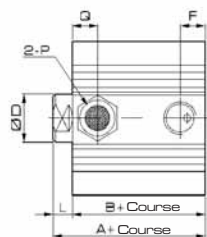

CDQ2-S-M

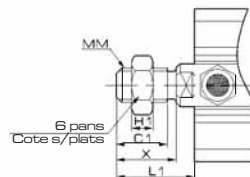

CDQ2A-S

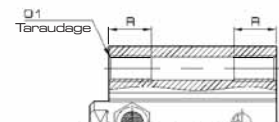

CDQ2-S Simple effet

Modèle	C.se	Sans Aimant				Avec Aimant				C	D	E	H	J	K	L	M	N	O	P	W	Z	B1	C1
		A	B	F	Q	A	B	F	Q															
CDQ2B32-S	5/10	40	33	7.5	10	50	43	7.5	10	13	16	45	M8x1,25	4.5	14	7	34	5.5	9 prof. 7	1/8	49.5	14	22	20.5
	15/20/25/30	50	43			60	53																	
CDQ2B40-S	5/10	36.5	29.5	7.5	12.5	56.5	49.5	7.5	12.5	13	16	52	M8x1,25	5	14	7	40	5.5	9 prof. 7	1/8	57	15	22	20.5
	15/20/25/30	46.5	39.5			66.5	59.5																	
CDQ2B50-S	5/10	38.5	30.5	10.5	10	58.5	50.5	10.5	10.5	15	20	64	M10x1.5	7	17	8	50	6.6	11 prof. 8	1/4	71	19	27	26
	15/20/25/30	48.5	40.5			68.5	60.5																	
CDQ2B63-S	5/10	44	36	10.5	15	64	56	10.5	15	15	20	77	M10x1.5	7	17	8	60	9	14 prof. 10.5	1/4	84	19	27	26
	15/20/25/30	54	46			74	66																	

Modèle	H1	L1	MM	X	O1	R
CDQ2B32-S	8	28.5	M14x1.5	23.5	M6x1	10
CDQ2B40-S	8	28.5	M14x1.5	23.5	M6x1	10
CDQ2B50-S	11	33.5	M18x1.5	28.5	M8x1.25	14
CDQ2B63-S	11	33.5	M18x1.5	28.5	M10x1.5	18

DIMENSIONS VÉRINS COMPACTS CDQ2 Simple Effet Tige Sortie T. 12 à 25

CDQ2B-T

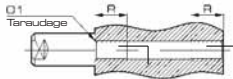

CDQ2B-T T.16 à 25

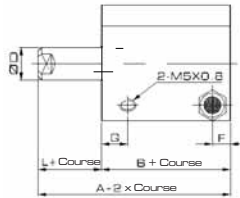

CDQ2-T-M

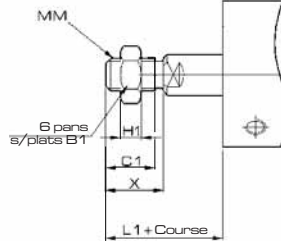
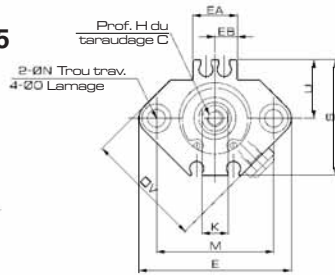

CDQ2B-T T.12

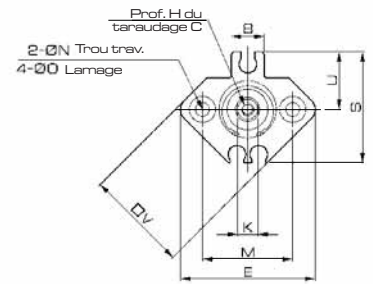

CDQ2-T Simple effet

Modèle	C.se	A	B	C	D	E	EA	EB	F	H	I	K	L	M	N	O	Q	S	U	V	B1	C1	H1	L1	MM	X	O1	R
CDQ2B12-T	5/10	41.5	38	6	6	33	--	--	7	M3	32	5	3.5	22	3.5	6,5 prof.3.5	7,5	27.5	14	25	8	9	4	14	M5	10.5	M4	7
	15/20	51.5	48																									
CDQ2B16-T	5/10	44	40.5	8	8	37	13.2	6.6	5.5	M4	38	6	3.5	28	3.5	6,5 prof.3.5	8	29.5	15	29	10	10	5	15.5	M6	12	M4	7
	15/20	54	50.5																									
CDQ2B20-T	5/10	46	41.5	7	10	47	13.6	6.8	5.5	M5	47	8	4.5	36	5.5	9 prof.7	8	35.5	18	36	13	12	5	18.5	M8	14	M6	10
	15/20/25/30	56	51.5																									
CDQ2B25-T	5/10	47.5	42.5	12	12	52	13.6	6.8	5.5	M6	52	10	5	40	5.5	9 prof.7	9	40.5	21	40	17	15	6	22.5	M10	17.5	M6	10
	15/20/25/30	52.5	52.5																									

DIMENSIONS VÉRINS COMPACTS CDQ2 Simple Effet Tige Sortie T. 32 à 63

CDQ2B-T

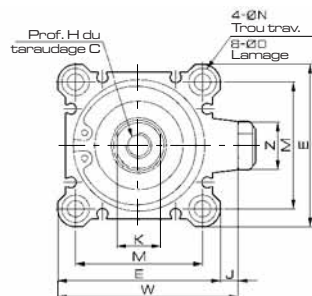
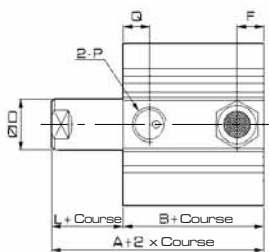

CDQ2-T-M

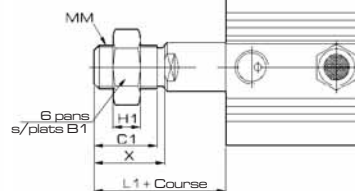

CDQ2A-T

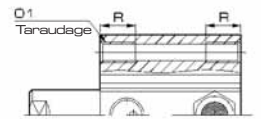

CDQ2-T Simple effet

Modèle	C.se	Sans Aimant				Avec Aimant				C	D	E	H	J	K	L	M	N	O	P	W	Z	B1	C1
		A	B	F	Q	A	B	F	Q															
CDQ2B32-T	5/10	40	33	7.5	10	50	43	7.5	10	13	16	45	M8x1,25	4.5	14	7	34	5.5	9 prof. 7	1/8	49.5	14	22	20.5
	15/20/25/30	50	43			60	53																	
CDQ2B40-T	5/10	36.5	29.5	7.5	12.5	56.5	49.5	7.5	12.5	13	16	52	M8x1,25	5	14	7	40	5.5	9 prof. 7	1/8	57	15	22	20.5
	15/20/25/30	46.5	39.5			66.5	59.5																	
CDQ2B50-T	5/10	38.5	30.5	10.5	10	58.5	50.5	10.5	10.5	15	20	64	M10x1.5	7	17	8	50	6.6	11 prof. 8	1/4	71	19	27	26
	15/20/25/30	48.5	40.5			68.5	60.5																	
CDQ2B63-T	5/10	44	36	10.5	15	64	56	10.5	15	15	20	77	M10x1.5	7	17	8	60	9	14 prof. 10.5	1/4	84	19	27	26
	15/20/25/30	54	46			74	66																	

Modèle	H1	L1	MM	X	O1	R
CDQ2B32-T	8	28.5	M14x1.5	23.5	M6x1	10
CDQ2B40-T	8	28.5	M14x1.5	23.5	M6x1	10
CDQ2B50-T	11	33.5	M18x1.5	28.5	M8x1.25	14
CDQ2B63-T	11	33.5	M18x1.5	28.5	M10x1.5	18